

**GASKET
MS27683
-90 THRU -96**

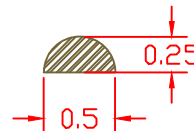

**ALT. GASKET
MS27683
-100 THRU -106**

COVER STYLE #1	CAPACITY GALLONS	A	B	GASKET	ALT. GASKET
MS27683-60	16 AND 19	15.34	0.75	MS27683-90	MS27683-100
MS27683-60A	16 AND 19	15.95	0.63	MS27683-90A	MS27683-100A
MS27683-61	20 AND 30	18.22	0.75	MS27683-91	MS27683-101
MS27683-62	22, 27, 38, 45 57 AND 61	22.47	0.75	MS27683-92	MS27683-102
MS27683-63	30, 60 AND 80	24.00	0.75	MS27683-93	MS27683-103
MS27683-64	34, 59 AND 79	26.00	0.69	MS27683-94	MS27683-104
MS27683-65	30, 60 AND 80	28.00	0.69	MS27683-95	MS27683-105
MS27683-66	29, 39, 58 AND 77	29.97	0.75	MS27683-96	MS27683-106

**MATERIAL: STEEL SPECIFICATION ASTM A1008/A1008M, COVER 18 GA. (MIN.)
FINISH AND MARKING: IN ACCORDANCE WITH PROCUREMENT SPECIFICATION
DIMENSIONS IN INCHES, UNLESS OTHERWISE SPECIFIED, TOLERANCE ON HEIGHTS
PLUS OR MINUS .12,
OTHER DIMENSIONS PLUS OR MINUS .03, ANGLES PLUS OR MINUS 2 DEGREES,**



300 Lake Road
Medina, Ohio 44256
sales@packspec.com
(330) 723-6000, (800) 344-9271
Fax (330) 725-8180

Tolerances Unless Otherwise Specified	Title DRUMS, METAL - SHIPPING AND STORAGE 18 TO 80 GALLONS
xx Decimals ± .03	Drawing No. PSI-MS27683 -
xxx Decimals ± .005	Sheet No. 2 OF 3
Angles ± 2°	Date 07/08/2022
PROCUREMENT SPECIFICATION	Designed By
MIL-DTL-6054G	Drawn By TD
	Checked By FT
Do not scale this drawing. Dimensions are in inches unless otherwise indicated.	